

Balustrade Elevation - (Typical)

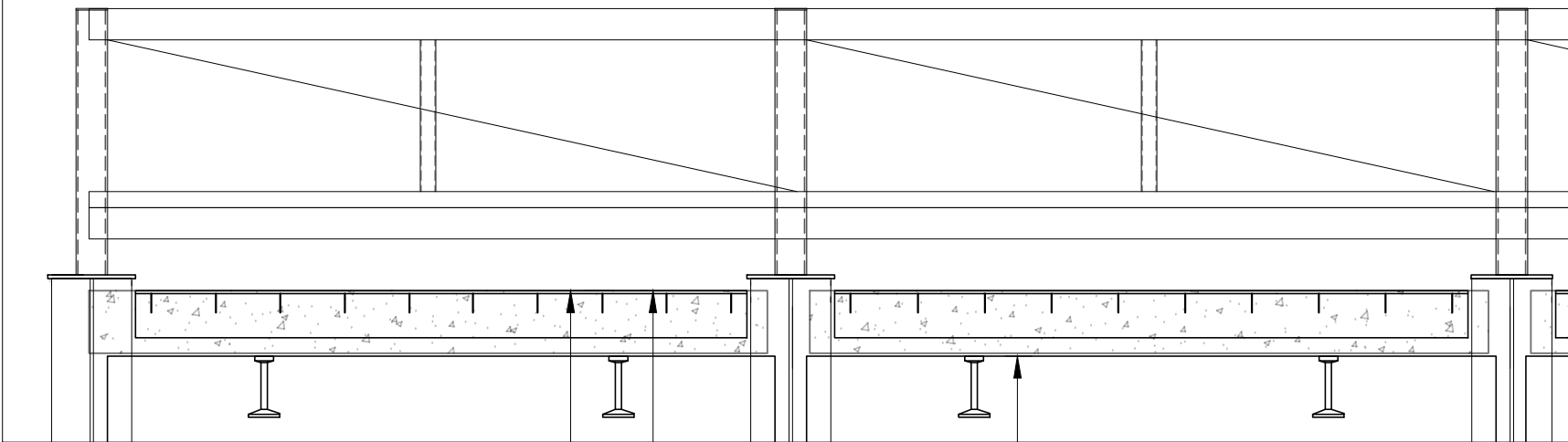

Balustrade - Detail 1

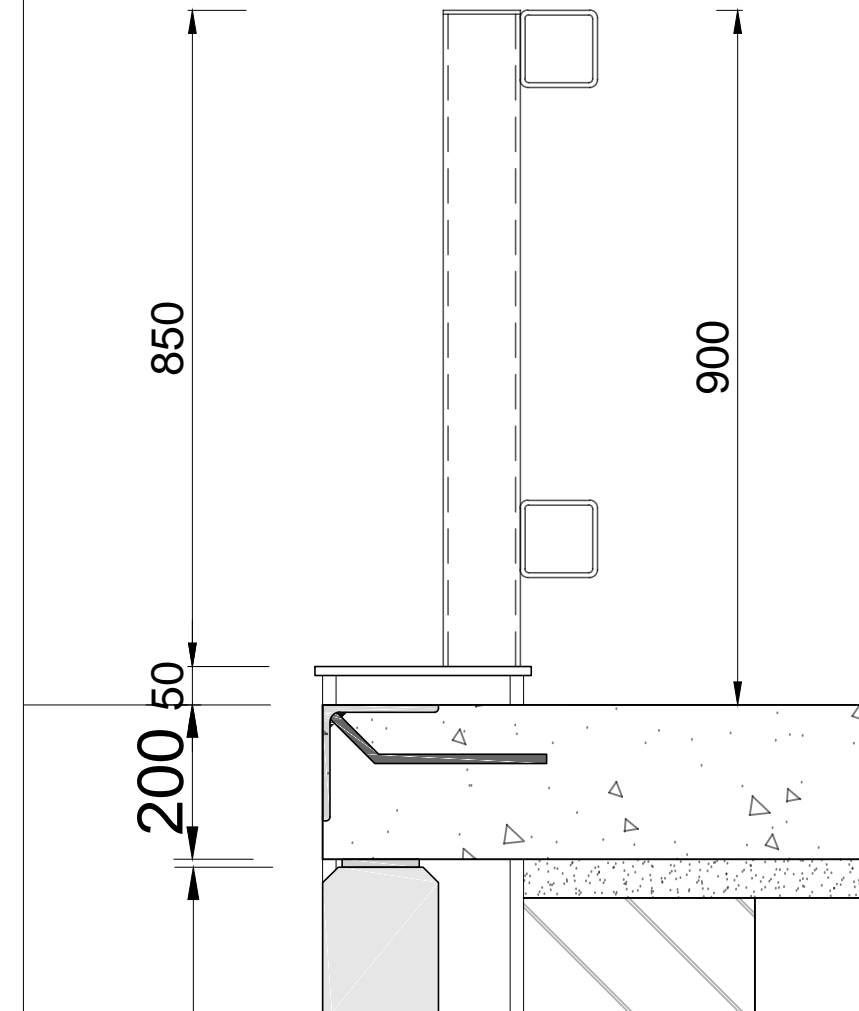

Balustrade - Detail 1

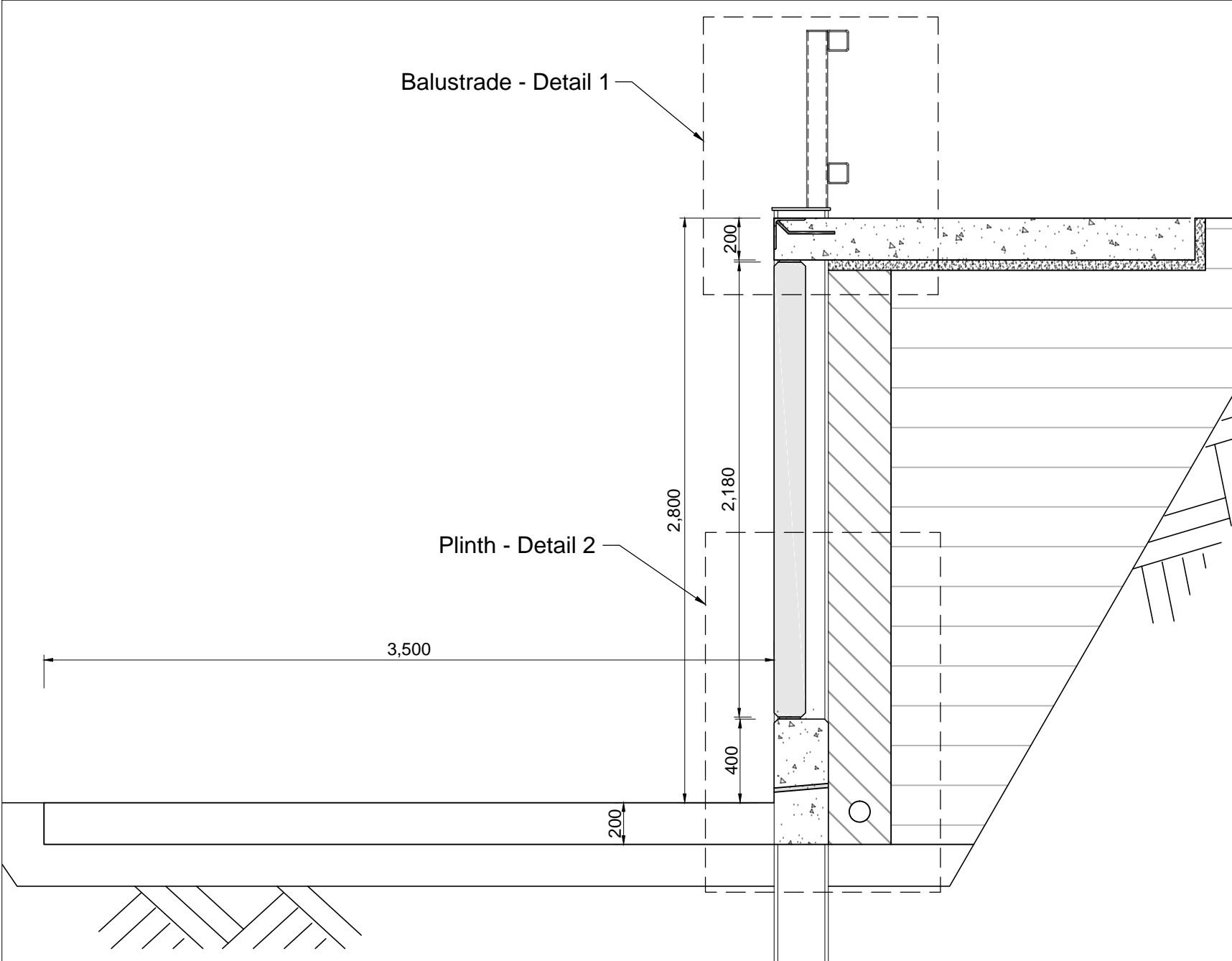

Plinth - Detail 2

3,500

2,800

2,180

200

400

200

Retaining Wall Section

150

400

260

600

Plinth - Detail 2

General Notes:

Revisions

No.	Date	Description
0	30/04/23	For Approval
1	02/05/23	Bin Block made darker & bumper SHS added
2	07/06/23	Balustrade & Plinth details added
3	25/06/23	revised balustrade
4	18/08/23	revised plinth to show precast & balustrade



CIVILVIC Pty Ltd
 ABN 72 631 227 408
 email: john@civilvic.com.au
 web: www.civilvic.com.au
 mob: 0412 574 369
 Commercial Builder
 CB-L 22108



Client
Strathbogie Shire

Project Name
Nagambie Transfer Station

Project Address
**854 McDonalds Rd
 Nagambie, VIC, 3608**

Drawing Name
Retaining Wall Section & Balustrade Details

Date: 19/08/2023

Drawn: John Dordevic

Status: Issued for Approval

Scale: N.T.S.

Paper Size: A3

Drawing No. Revision

N 3

4